

# CONNECT

## @ GUNNING STATION

Connect@Gunning Station includes three gallery spaces and an additional room for workshops.

Gallery spaces have level access. The signal box room is accessible by ramp.

Each Gallery space has a hanging system installed for the display of 2D works of art with gallery lighting.

Gallery Spaces are not airconditioned but have potable heating and fans for warmer weather.

### Parcels Gallery

Our most intimate gallery space at the Eastern end of the Connect buildings. The Parcels Gallery has a track hanging system installed and has natural light as well as spot lighting for works. There is also a mantle over the heritage fireplace for display of works up to 30cm wide.

The Parcels Gallery has access to portable heating and fans for warmer weather.

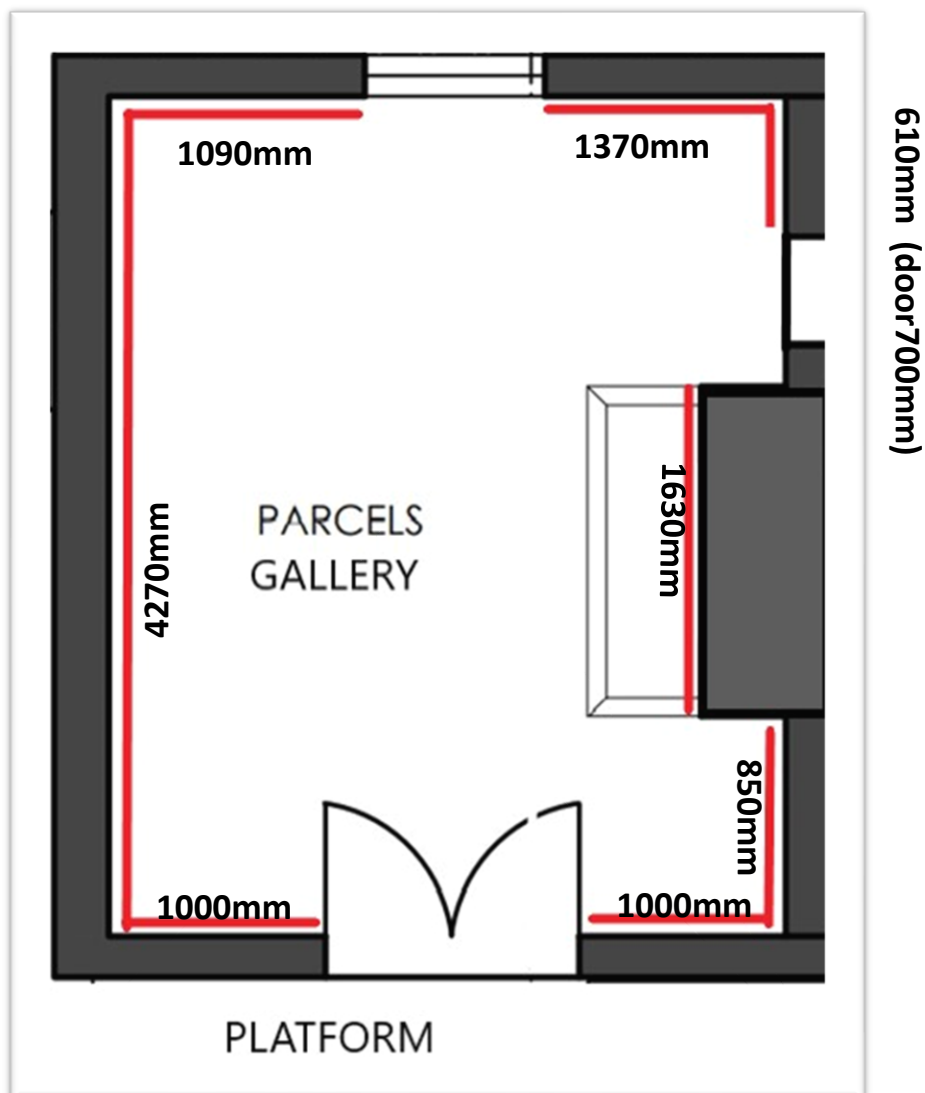

## Main Gallery

The old Main waiting room of the train station includes door entry from both the carpark and platform side of the station. The Main Gallery has a track hanging system installed and has natural light as well as spot lighting for works. There is window into the old ticket office and a mantle over the heritage fireplace for display of works up to 30cm wide.

The Main Gallery has access to portable heating and fans for warmer weather.

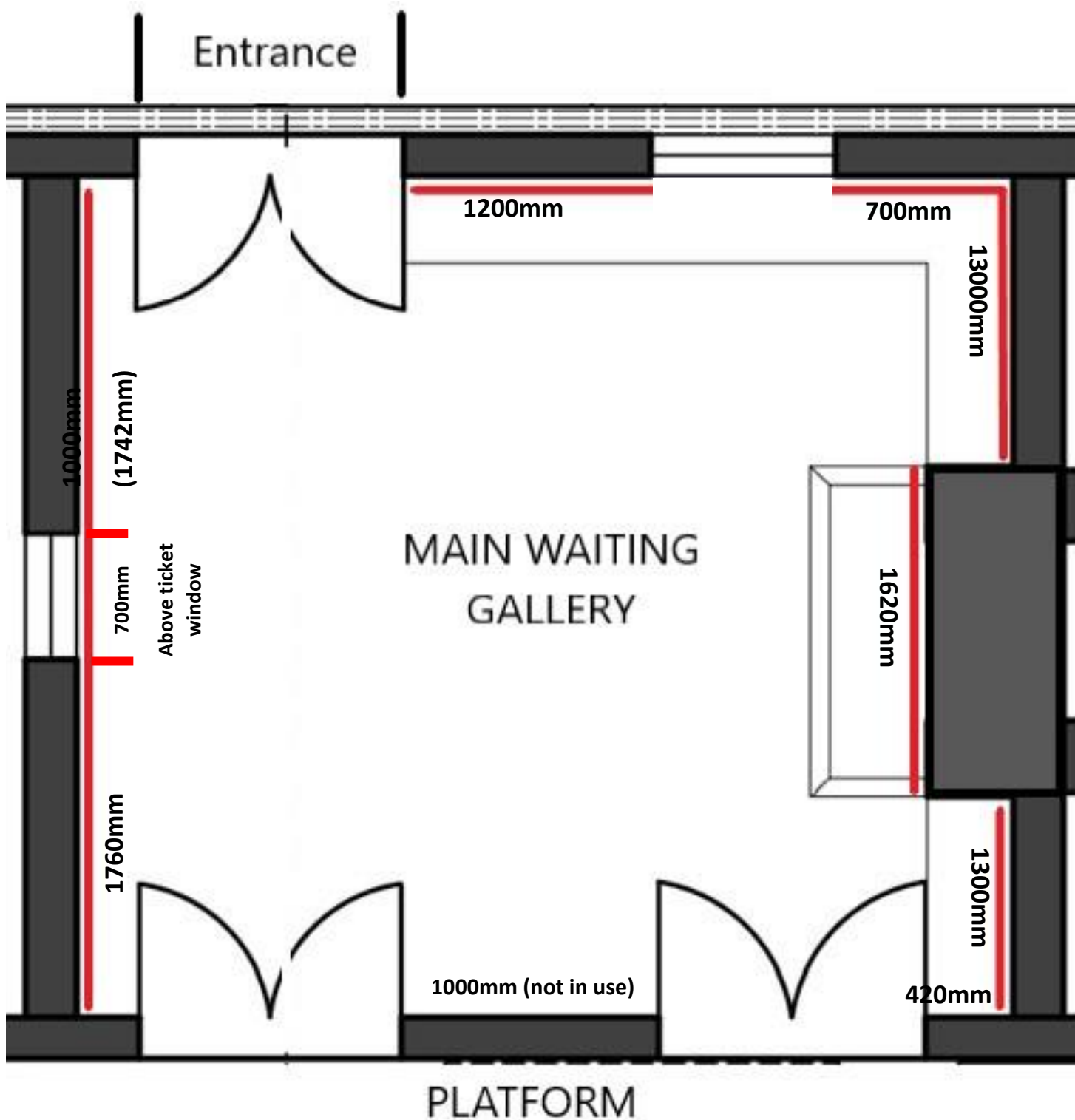

## The Ladies Gallery

The Ladies Gallery is the old ladies waiting room and includes a unisex toilet accessible at the back of the gallery space. The Ladies Gallery has a track hanging system installed and has natural light as well as spot lighting for works. There is a mantle over the heritage fireplace for display of works up to 30cm wide.

The Ladies Gallery has access to portable heating and fans for warmer weather.

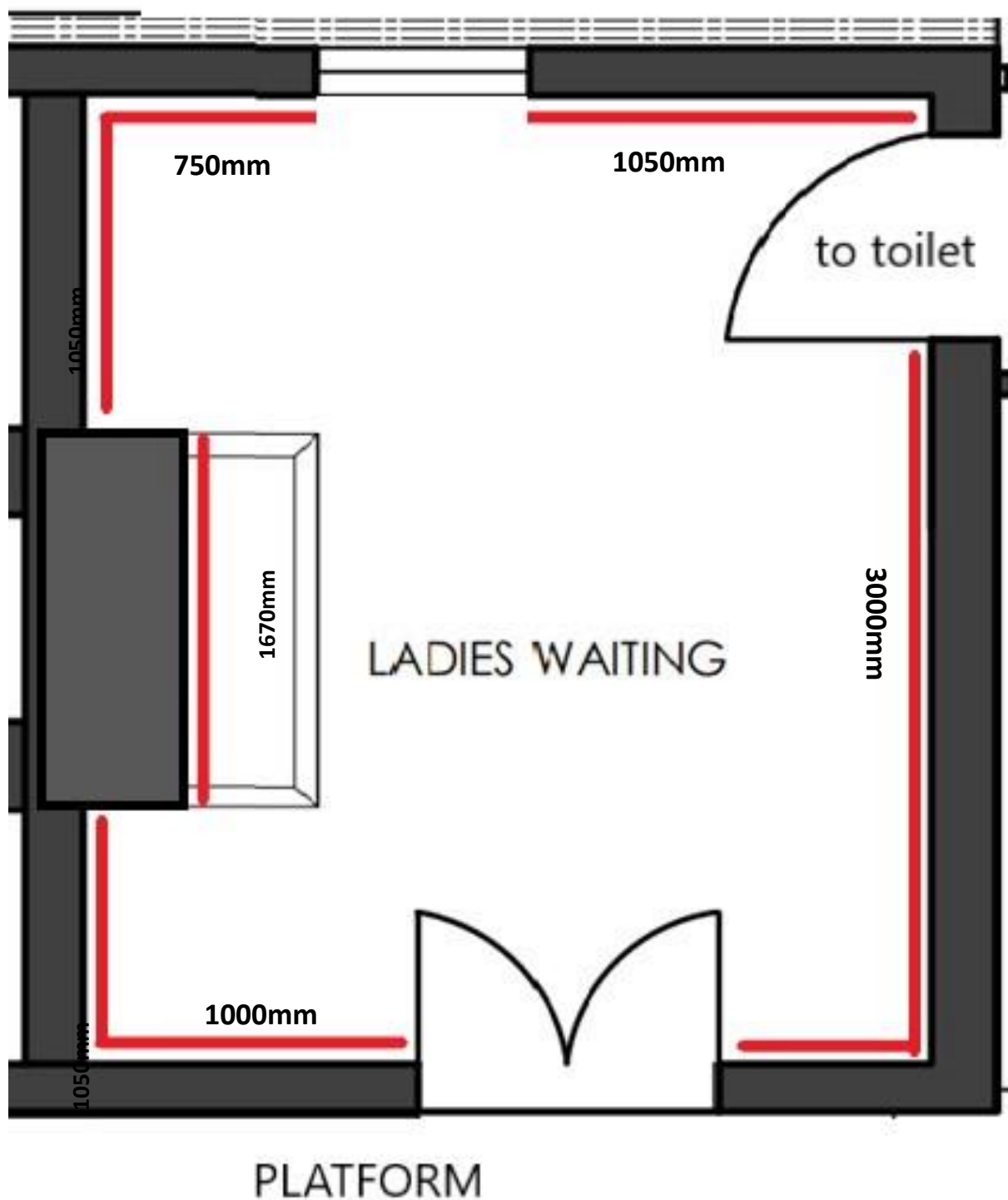

## Signal Box Room

The Signal Box Room is our space for workshops and meetings.

The Signal Box room is a free-standing structure at the Western end of the station platform. The room is heritage weatherboard outside and lined with timber painted cream. The Signal Box has two entrance doors, one accessible by ramp. The space is flooded with natural light due to the intensive windows on the platform side.

There is no hanging system in the signal box room and the space is perfect for workshops and meetings. The Signal Box room is airconditioned. Ramp access to the room is via the western entry door the Eastern door is up one step to enter.

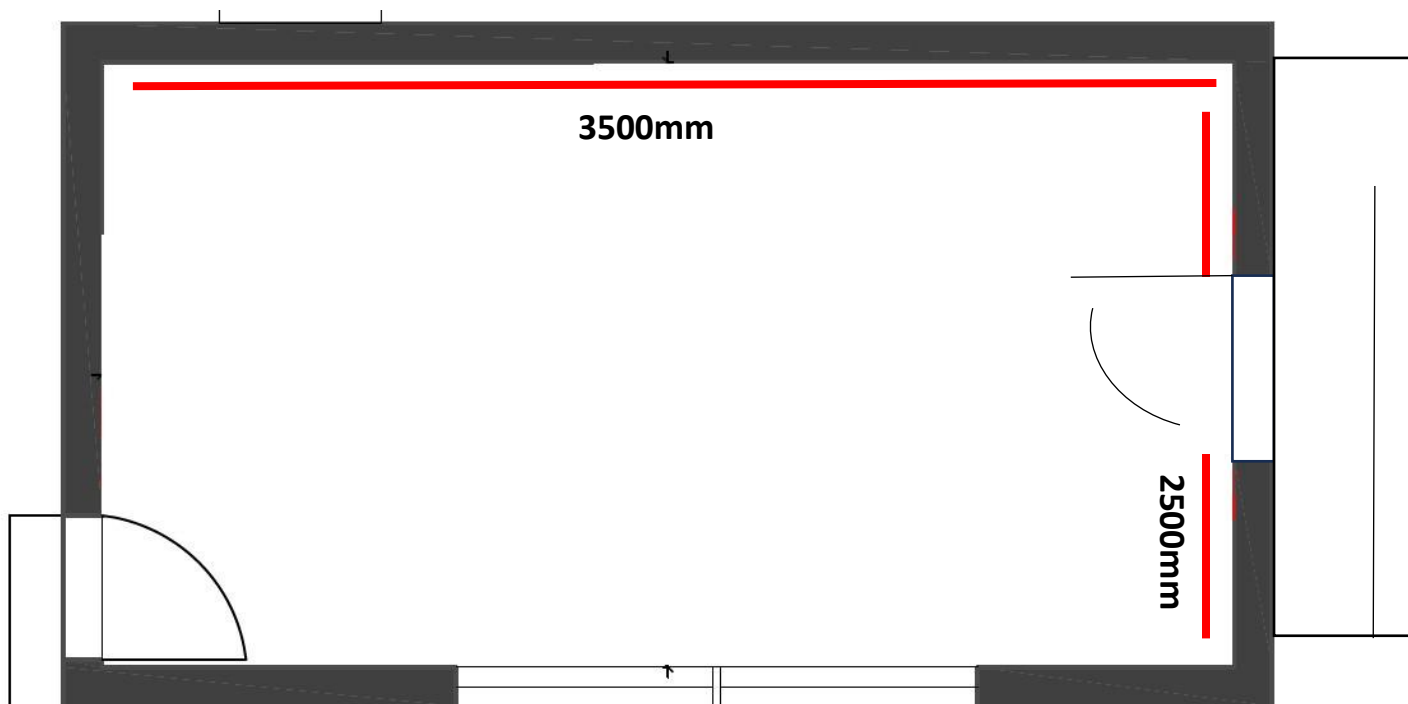

SIGNAL BOX

